

Quick-fitting Type Three-way Changeover Valve

Change Valve

Features

- The Change Valve switches the passages of air.
- The valve made of resin is compact and lightweight.
- This highly operative valve offers easy switching of fluid passages. (switching angle: 90°)

Construction

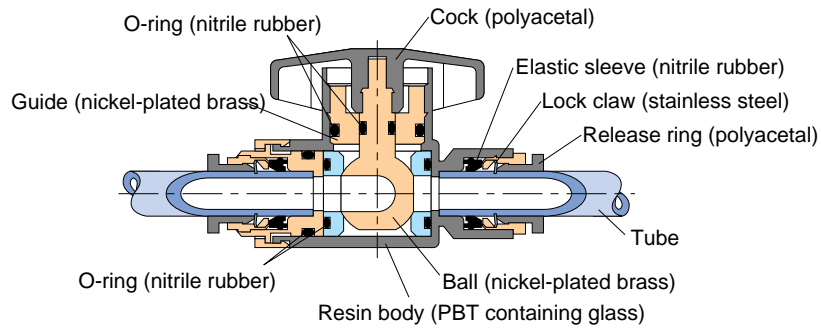

Specification

Fluid admitted	Air	
Service pressure range	0~100psi	0~0.7MPa
Working vacuum	-29.5in. Hg	-100KPa
Service temperature range	32~140°F	0~60°C

Model Designation (Example)



(1) Type

(2) Tube dia

Code	6	8	10	12
Size(mm)	φ6	φ8	φ10	φ12
in. size	1/4	5/16	3/8	1/2
	φ1/4	φ5/16	φ3/8	φ1/2

(3) Tube dia

Code	6	8	10	12
Size(mm)	φ6	φ8	φ10	φ12
in. size	1/4	5/16	3/8	1/2
	φ1/4	φ5/16	φ3/8	φ1/2

Application example

- Turn the cock 90°, and the passage switches to the other.

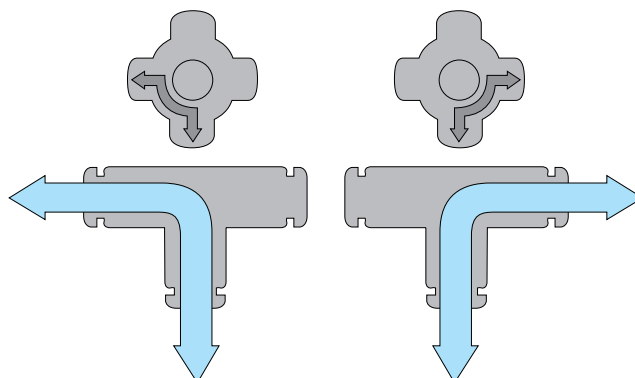

⚠ Detailed Safety Instructions

Before using the PISCO device, be sure to read the "Safety Instructions", "Common Safety Instructions for Products Listed in This Manual" on page 23~24 and "Common Safety Instructions for Change Series Valves" on page 279.

⚠ Caution

1. When operating the cock, turn it 90 degrees completely until it stops. Inadequate turning may result in poor conduction or low flow rate due to faulty switching.
2. Check the arrow mark on the cock before actually introducing air.
3. For use with negative pressures, provide a vacuum filter on the suction side. Otherwise dust sucked in may cause malfunction.

HBV

Union Type

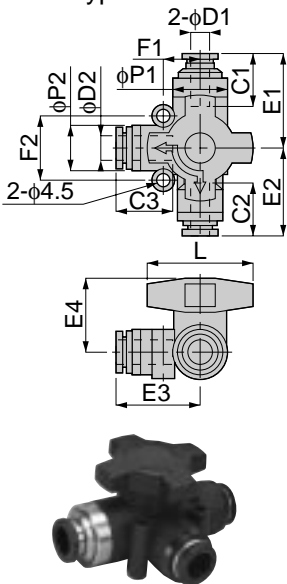

unit:mm

Model	Tube dia. φD1	Tube dia. φD2	L	φP1	φP2	C1	C2	C3	E1	E2	E3	E4	F1	F2	Mass (g)
HBV 6-6	6	6	35	17.5	14.5	17	17	17	27	29	27	24	12	20	50.5
HBV 8-6	6	8	35	17.5	14.5	17	17	18.5	27	29	27	24	12	20	51
HBV 8-8	8					18.5	18.5		28.5						50
HBV 10-10	10	10	44	24	21	21	21.5	21.5	36.5	37	35	28	15	25	122.5
HBV 12-10	10	12	44	24	21	21	21.5	23.5	36.5	37	35	28	15	25	123.5
HBV 12-12	12					23.5	23.5		37						118.5

Model	Orifice dia. (φmm)	Eff. Area (mm ²)
HBV 6-6	5	9
HBV 8-6	5	11
HBV 8-8	6	17
HBV 10-10	9	24
HBV 12-10	9	24.5
HBV 12-12		34.5