



Certificate

Certificate of registration

QUALITY ASSURED COMPANY
ISO 9001 : 2000

THIS IS TO CERTIFY THAT THE
QUALITY MANAGEMENT SYSTEM OF

UNI-D CORPORATION
R.O.C. 2820064
(The Factory Name of DI-HEN CORPORATION)



No.30-6, Lane 300, San-Min Road, Lu-Chow City, Taipei Hsien, Taiwan, R.O.C.
No.406, Shen Jong St., Shyh Lin Dist., Taipei, Taiwan, R.O.C.

Has been assessed and registered as complying with the requirements of the International Standard shown above for the following Goods and Services. Further clarifications regarding the scope of this certificate and the applicability of ISO 9001 : 2000 requirements may be obtained by consulting the organization.

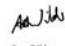
Design and Manufacture of Solenoid Valve 1/8" - 4" and Motor Valve 1/2" - 6"

Tony Wilde
Managing Director
ISC Pty Ltd, c/o 100 Victoria
Sydney, Australia

Registration Number: QAC/9886/0218
Registration Date: 16-May-01
Valid for: 3 Years
Page 1 of 1

ISO 9001

ITS Intertek Testing Services
ETL SEMKO

VERIFICATION
of conformity with European Directive(s)
No. CE-0201400

Type of equipment: Valve Actuators
Document holder: Uni-D Corporation
No. 406, Shen Jong Street, Shih Lin Dist., Taipei, Taiwan R.O.C.
Manufacturer: Di-Hen Corporation
No. 30-6, Lane 300, San-Min Road, Lu-Chow City Taipei Hsien, Taiwan R.O.C.
Type designation: UM-1, UM-2, UM-3
Technical data: 230Vac, 50/60Hz, Class, Type 18JP 20

A sample of the equipment has been tested for CE-marking according to the EC Directive(s),
- the Low Voltage Directive, 73/23/EEC, 93/MA/EEC
- the EMC Directive, 89/367/EEC

Standard(s) used for showing compliance with the essential requirements of the directive

Standard(s)	Test report(s)	Issued by	Date(s)
EN 60730-1:2000 and EN 60730-2:1995	ITS-020128	ITS-Taiwan	Apr. 12, 2002
*A1: 1997(A2): 1997			
-A1(A): 2000			
EN 61000-3-2: 1995(A1): 1998	EME-020053	ITS-Taiwan	Mar. 19, 2002
EN 61000-3-3: 1995	EME-020053	ITS-Taiwan	Mar. 19, 2002
EN 61326-1: 1997(A1): 1998	EME-020053	ITS-Taiwan	Mar. 19, 2002
EN 50111: 1993(A2): 1997(A2): 1998	EME-020053	ITS-Taiwan	Mar. 19, 2002
EN 61000-4-2: 1995	EME-020053	ITS-Taiwan	Mar. 19, 2002
EN 61000-4-3: 1996(A1): 1998	EME-020053	ITS-Taiwan	Mar. 19, 2002
EN 61000-4-4: 1995	EME-020053	ITS-Taiwan	Mar. 19, 2002
EN 61000-4-5: 1995	EME-020053	ITS-Taiwan	Mar. 19, 2002
EN 61000-4-6: 1996	EME-020053	ITS-Taiwan	Mar. 19, 2002
EN 61000-4-8: 1996	EME-020053	ITS-Taiwan	Mar. 19, 2002
EN 61000-4-11: 1994	EME-020053	ITS-Taiwan	Mar. 19, 2002

The referred test report(s) show that the product fulfills the requirements in the European Directive(s) for CE marking. On this basis, together with the manufacturer's own document production control, the manufacturer (or his European authorized representative) can in his EC Declaration of Conformity verify compliance with the European Directive(s).

Taipei
Apr. 12, 2002

Intertek Testing Services Taiwan Ltd.

VINCENT TAN
ASSISTANT MANAGER
ETL SEMKO TESTING



CE

CSA INTERNATIONAL

Certificate of Compliance

Certificate: 1341960
Master Contract: 216806
Project: 1341960
Date issued: November 21, 2002

Issued to: Uni-D Corporation
No. 406, Shen Jong St.,
Shih Lin Dist.,
Taipei, Taiwan

The products listed below are eligible to bear the CSA Mark shown, with adjacent indicator "C" and "US".

Issued by: Sebastian George, P. Eng.

Authorized by: 
Director, Far East Operation

PRODUCTS
CLASS 2221-02 - VALVES - Actuators
CLASS 2221-02 - VALVES - Actuators - CERTIFIED TO U.S. STANDARDS

Motor control units for electrically operated valves, indoor, intermittent duty, one cycle in 3 minutes, Class A insulation, thermally protected, rated 120 V ac, 60 Hz.

Table 1: Model UM-1, rated 0.55 A, 61 W, 10 sec per cycle (open or close)
Table 2: Model UM-2, rated 0.55 A, 61 W, 10 sec per cycle (open or close)
Table 3: Model UM-3, rated 0.75 A, 79 W, 30 sec per cycle (open or close)
Table 4: Model UM-3.1, rated 0.75 A, 79 W, 30 sec per cycle (open or close)
Table 5: Model UM-4, rated 0.75 A, 79 W, 30 sec per cycle (open or close)
Table 6: Model UM-5, rated 1.22 A, 135 W, 30 sec per cycle (open or close)
Table 7: Model UM-6, rated 1.22 A, 135 W, 30 sec per cycle (open or close)

Note: Certified only as a component of other certified equipment where the suitability of the combination is to be determined.

APPLICABLE REQUIREMENTS
CSA C22.2 No. 1-91-1982 - Electrically Operated Valves
CSA C22.2 No. 190-95 - Motors and Generators
UL CEN, Fifth Edition - Electrically Operated Valves
UL 1084, Fifth Edition - Electric Motors

The "C" and "US" indicate approval to the CSA Mark register that the product has been evaluated to the applicable AMSE/UL and CSA standards, for use in the U.S. and Canada. This includes product design to meet the UL/ULC, UL/ULC, or UL/ULC Standard Testing Laboratory, in a laboratory granted by the U.S. Department of Energy and Health Administration (DHHS) in laboratories which have been recognized to perform certification to U.S. standards.

1000-01-01-01-01

CSA

IP67



UL 429 ISO 9001
Serial No : 216806

UM Direct Mounting Series

Model	The Size Of Valve						Max Operating Pressure Diff (Kgf/cm ²)	Weight (kg)
	Screwed Ends	Flanged Ends	True Union Ball Valve (Plastic)	Butterfly Valve	3-Way Valve	Gate Valve		
UMS	1/4" ~ 1"				1/2" ~ 3/4"		10	1
UM-1	1/4" ~ 1 1/2"	1/2" ~ 1"			1/2" ~ 1"		10	1.6
UM-2	1" ~ 2"	1 1/4" ~ 2"		2" ~ 3"	1 1/4" ~ 1 1/2"		10	2.3
UM-3	1 1/4" ~ 3"	1 1/4" ~ 3"		2" ~ 4"	2 1/2"		10	4.2
UM-3-1	1 1/4" ~ 3"	1 1/4" ~ 3"		2" ~ 4"	2 1/2"		10	7
UM-4	20 sec 2" ~ 3"	1 1/4" ~ 3"		4" ~ 5"	2 1/2"		10	7
	30 sec 4"	4"		5" ~ 8"	2 1/2" ~ 3"		10	8.5
UM-5		5"		10"	4"		10	8.9
UM-6		6"		12"	5"		10	9.2

UM Series with Mounting Kit

Model	The Size Of Valve						Max Operating Pressure Diff (Kgf/cm ²)	Weight (kg)
	Screwed Ends	Flanged Ends	True Union Ball Valve (Plastic)	Butterfly Valve	3-Way Valve	Gate Valve		
UMS	1/4" ~ 1"		1/2" ~ 1"		1/2" ~ 3/4"		10	1
UM-1	1/4" ~ 1 1/2"	1/2" ~ 1"	1/2" ~ 1 1/2"		1/2" ~ 1"		10	1.5
UM-2	1" ~ 2"	1 1/4" ~ 2"	2"	2" ~ 3"	1 1/4" ~ 1 1/2"		10	2.3
UM-3	1 1/4" ~ 3"	1 1/4" ~ 3"	2" ~ 3"	2" ~ 4"	2 1/2"		10	6
UM-3-1	1 1/4" ~ 3"	1 1/4" ~ 3"	1 1/4" ~ 3"	2" ~ 4"	2 1/2"		10	7.5
UM-4	20 sec 2" ~ 3"	1 1/4" ~ 3"	1 1/4" ~ 3"	4" ~ 5"	2 1/2"		10	7.5
	30 sec 4"	4"	4"	5" ~ 8"	2 1/2" ~ 3"		10	8.3
UM-5		5"		8" ~ 10"	4"		10	10.8
UM-6		6"		10" ~ 12"	5"		10	11
UM-8		8"		12" ~ 14"	6"		10	32
UM-10		10"		14" ~ 16"			10	34
UM-11		12"		16" ~ 18"			10	34
UM-12		14"		20" ~ 24"			10	60
UMB						2" ~ 6"	10	
UMD	1/4" ~ 4"	1/2" ~ 14"	1/2" ~ 4"	2" ~ 24"	1/2" ~ 6"		10	

All products spcification is reference material

Pressure 0 ~ 10kgf/cm² :

Formula For Ball Valve : Troque 0 ~ 1000 kgf-cm x 1.5X / Troque 0 ~ 10000 kgf-cm x 1.3X

Formula For Butterfly Valve : Troque 0 ~ 1000 kgf-cm x 1.5X / Troque 0 ~ 10000 kgf-cm x 1.3X

24VAC Specification

Model	Power	Speed 90° sec (60Hz)	Torque(±5%) kgf-cm 24VAC	24VAC	Weight (Kg)	ISO 5211 Mounting Pattern
UMS	3~4W	23	150	170mA	1	○

110VAC/220VAC Specification

Model	Power	Speed 90° sec (60Hz)	Torque(±5%) kgf-cm 110VAC	Torque(±5%) kgf-cm 220VAC	100~120 VAC	200~240 VAC	Weight (Kg)	ISO 5211 Mounting Pattern
UMS	3~4W	23	150	150	33mA	30mA	1	○
UM-1	10W	1	75	80	0.4A	0.25A	1.5	
UM-1	10W	5	181	214	0.4A	0.25A	1.5	○
UM-1	10W	10	350	362	0.4A	0.25A	1.5	○
UM-1	15W	1	127	132	0.8A	0.5A	1.5	
UM-1	15W	10	410	432	0.8A	0.5A	1.5	○
UM-2	10W	20	480	502	0.4A	0.25A	2.3	○
UM-2	15W	20	655	677	0.8A	0.5A	2.3	○
UM-3	25W	1	294	350	0.76A	0.42A	6	○
UM-3	25W	8	1486	1562	0.76A	0.42A	6	○
UM-3	40W	1	369	405	0.95A	0.58A	6	○
UM-3	60W	1	445	460	1.2A	0.66A	6	○
UM-3-1	25W	1	294	350	0.76A	0.42A	7.5	○
UM-3-1	25W	8	1486	1562	0.76A	0.42A	7.5	
UM-3-1	40W	1	369	405	0.95A	0.58A	7.5	○
UM-3-1	60W	1	445	460	1.2A	0.66A	7.5	○
UM-4	25W	20	2500	2500	0.76A	0.42A	8.3	○
UM-4	25W	30	3118	3320	0.76A	0.42A	8.3	○
UM-5	40W	30	4266	4873	0.95A	0.58A	10.8	○
UM-6	60W	30	5689	6081	1.2A	0.66A	11	○
UM-8	100W	37	11038	9296	0.92A	0.34A	32	
UM-10	100W	52	12060	13500	0.92A	0.34A	34	
UM-11	100W	65	15000	14500	0.92A	0.34A	34	
UM-12	100W	143	35000	35000	0.92A	0.34A	60	

24VDC Specification

Model	Power	Speed 90° sec (60Hz)	Torque(±5%) kgf-cm 24VDC	24VDC	Weight (Kg)	ISO 5211 Mounting Pattern
UM-1	10W	2	100	0.5A	1.5	
UM-1	10W	15	438	0.5A	1.5	○
UM-2	10W	30	622	0.5A	2.3	○
UM-3	30W	1	506	0.5A	6	○
UM-3	30W	8	1660	0.5A	6	○
UM-3-1	30W	1	506	0.5A	7.5	○
UM-3-1	30W	8	1660	0.5A	7.5	○
UM-4	30W	20	2630	0.5A	8.3	○
UM-4	30W	30	3405	0.5A	8.3	○
UM-6	65W	30	6232	1.5A	11	○

General Description

1. UM-1 to UM-6 provide direct mounting on ISO 5211 Valve.
2. UM series is low power consumption, high efficiency and excellent weatherproof heavy-duty motor.
3. All the joint on the housing are armed with waterproofing seal(IP67), which is applicable for use in outdoor environment.
4. Stabilized start speed to effectively avoid water hammering for prolonging the service life tubes.
5. The UM series have continuous mechanism position indication.
6. All UM series provide thermal protector.

Standard Voltage

- 100VAC ~ 120VAC
- 200VAC ~ 250VAC
- 24VDC or other special voltage

Enclosure

1. IP67 waterproof and dustproof enclosure.
2. Made of "AA"「NYLON」or Aluminum Alloy which has purpose of resisting against heat, acid , alkali, waterproof, dustproof.

Cautions

- 1 Electric actuator away from the area using gas or chemical substance which is vulnerable to gas explosion to avoid the occurrence of hazard.
2. Be sure to voltage and wiring is correct.
3. The inner part have to clear before installed.
4. Adjusting valve position, open cover then adjusting the CAM (Hexagonal head wrench 2.5H). After complete adjusting, be sure to screw is tight.
5. **Prohibition drive the valve when the valve lock.**

Valve

UM series provide mounting on ISO 5211 valve or non ISO 5211 valve.

Option

- | | | | |
|--------------------------|---------------------------|------------------|----------|
| 1. Temp controller | 2. Limit switch (2 units) | 3. Heater | 4. Relay |
| 5. Modulating controller | 6. Modulating control box | 7. Local Control | |

Approvals

- | | | |
|------------|---------|--------|
| • ISO 9001 | • CSA | • IP67 |
| • CE | • UL429 | |

UMS Direct Mount Series



Weight : 1 kg

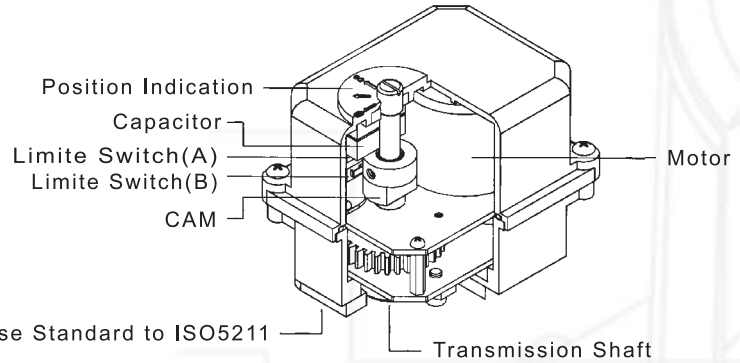

Specification				Speed(sec)		Output Torque Kgf-cm		
Power	24VAC	110VAC	220VAC	AC	DC	24VAC	110VAC	220VAC
3~4W	170 mA	33 mA	30 mA	23	N/A	150	150	150

The Size Of Valve		
Screwed Ends	3-Way Valve	True Union Ball Valve(Switch Kit Only)
1/4" ~ 1"	1/2" ~ 3/4"	1/2" ~ 1"

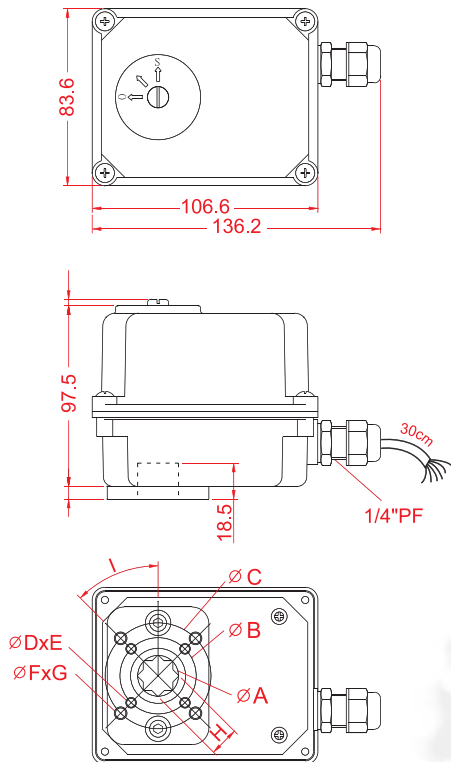

* Option : (1) H=9", A=12 (2) H=11", A=15

* F04/F07 D=M5, F=M8 Optional

Dimension (mm)	A	B	C	D	E	F	G	H	I	ISO 5211
Model										
UMS	19	36	50	M5	4	M6	4	14	45°	F03 / F05

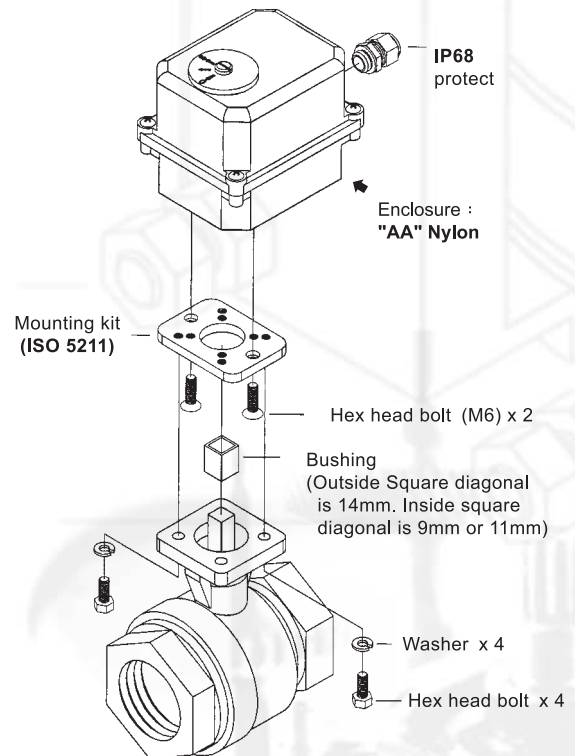

Mounting Pattern :

	bore distance (P.C.D)	Hex head bolt size
mounting pattern	ø 36 (P.C.D)	M5 x P0.8 x 12L
	ø 50 (P.C.D)	M6 x P1.0 x 15L

UM-1 Direct Mount Series



Weight : 1.6 kg

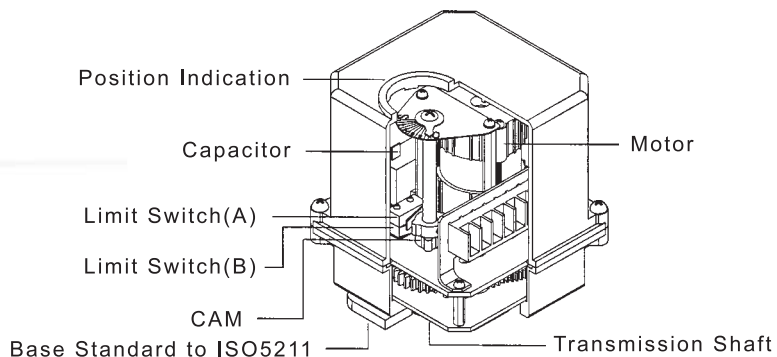

Specification				Speed(sec)		Output Torque Kgf-cm		
Power	110VAC	220VAC	24VDC	AC	DC	110VAC	220VAC	24VDC
10W	0.4A	0.25A	0.5A	10	15	350	362	438
15W	0.8A	0.5A	N/A	10	N/A	410	432	N/A

The Size Of Valve		
Screwed Ends	Flanged Ends	3-Way Valve
1/4" ~ 1 1/2"	1/2" ~ 1"	1/2" ~ 1"

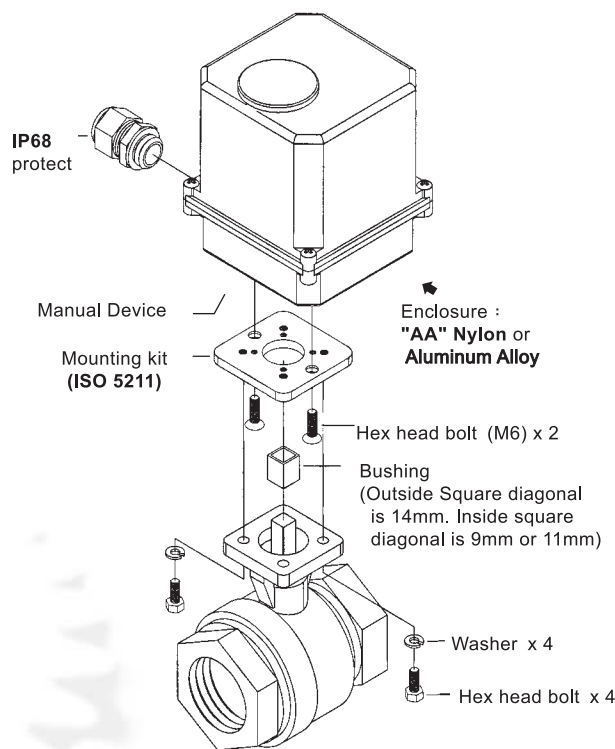
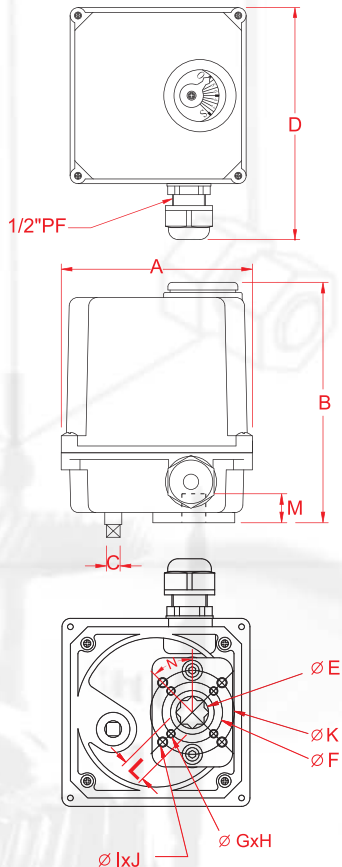

Mounting Pattern :

mounting pattern	bore distance (P.C.D)	Hex head bolt size
A	ø 36 (P.C.D)	M5 x P0.8 x 12L
	ø 50 (P.C.D)	M6 x P1.0 x 15L
B	ø 50 (P.C.D)	M5 x P0.8 x 12L
	ø 70 (P.C.D)	M8 x P1.2 x 15L

Dimension (mm)	A	B	C	D	E	F	G	H	I	J	K	L	M	N	ISO 5211
Model															
UM-1	112	144	8	148	19	36	M5	4	M6	4	50	14	18.5	45	F03 / F05

UM-2 Direct Mount Series



Weight : 2.3 kg

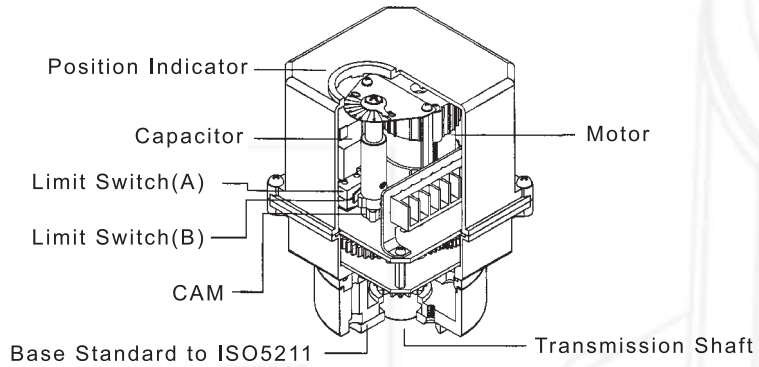

Specification				Speed(sec)		Output Troque Kgf-cm		
Power	110VAC	220VAC	24VDC	AC	DC	110VAC	220VAC	24VDC
10W	0.4A	0.25A	0.5A	20	30	480	502	622
15W	0.8A	0.5A	N/A	20	N/A	655	677	N/A

The Size Of Valve			
Screwed Ends	Flanged Ends	Butterfly Valve	3-Way Valve
1" ~ 2"	1 1/4" ~ 2"	2" ~ 3"	1 1/4" ~ 1 1/2"

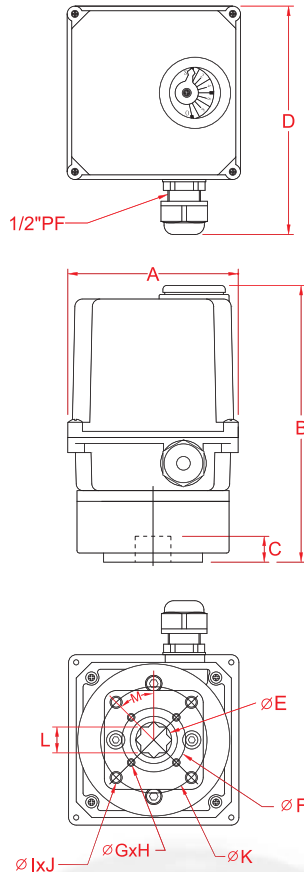

Dimension (mm)	A	B	C	D	E	F	G	H	I	J	K	L	M	ISO 5211
Model														
UM-2	112	185	19.5	148	23.5	42	M5	4	M8	4	70	17	45°	F04 / F07

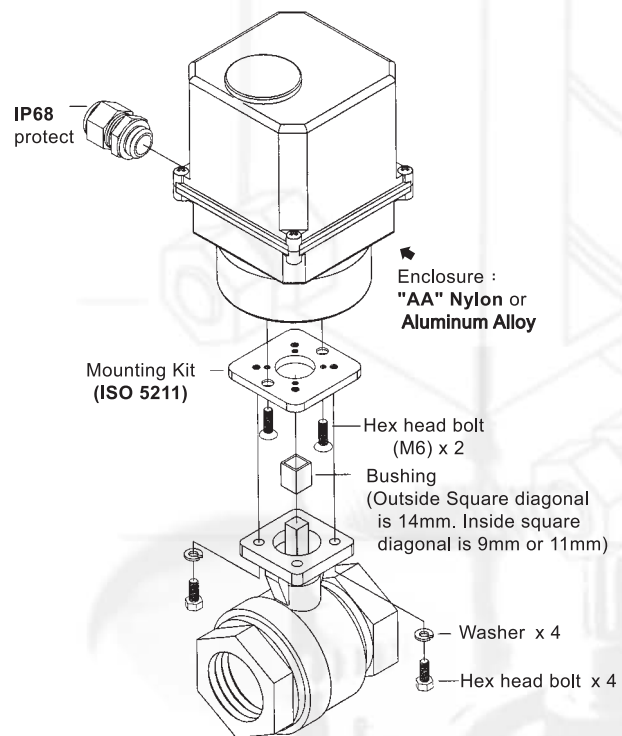

Mounting Pattern:

mounting pattern	bore distance (P.C.D)	Hex head bolt size
A	ø 36 (P.C.D)	M5 x P0.8 x 12L
	ø 50 (P.C.D)	M6 x P1.0 x 15L
B	ø 42 (P.C.D)	M5 x P0.8 x 12L
	ø 70 (P.C.D)	M8 x P1.2 x 15L

UM-3 Direct Mount Series



Weight : 4.2 kg

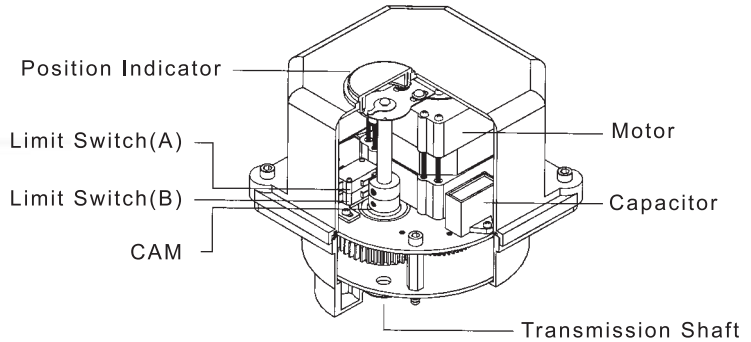

Specification				Speed(sec)		Output Torque Kgf-cm			
Power	110VAC	220VAC	24VDC	AC	DC	110VAC	220VAC	24VDC	
25W	0.76A	0.42A	N/A	1	N/A	294	350	N/A	
				8		1486	1562		
30W	N/A		0.5A	N/A	1	N/A		506	
					8			1660	

The Size Of Valve			
Screwed Ends	Flanged Ends	Butterfly Valve	3-Way Valve
1 1/4" ~ 3"	1 1/4" ~ 3"	2" ~ 4"	2 1/2"

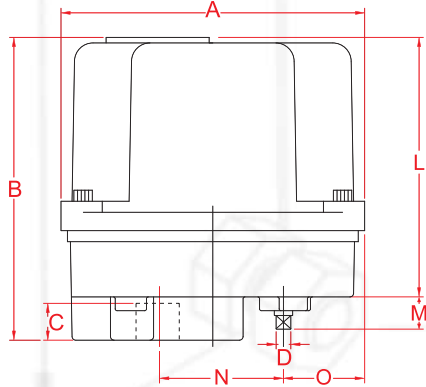

*The UM-3/24VDC is over standard height 26mm.

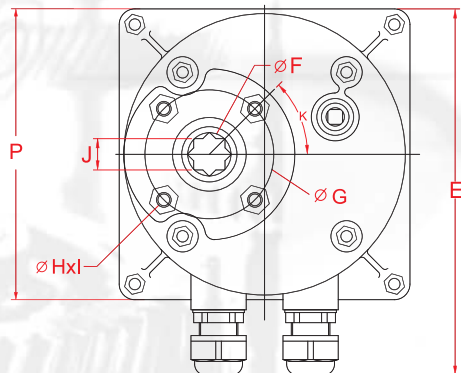

Enclosure :
"AA" Nylon or
Aluminum Alloy

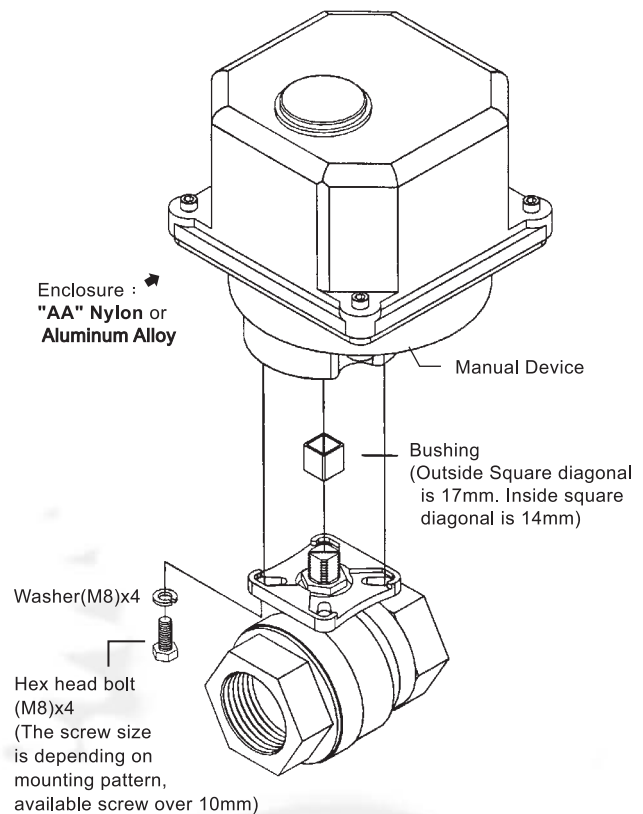

Dimension (mm)	A	B	C	D	E	F	G	H	I	J	K	L	M	N	O	P	ISO 5211
Model																	
UM-3	165	165	20	8	200	23.5	70	M8	M6	17	45°	141	17.3	68.39	44.2	165	F07

UM-3-1 Direct Mount Series



Weight : 7 kg

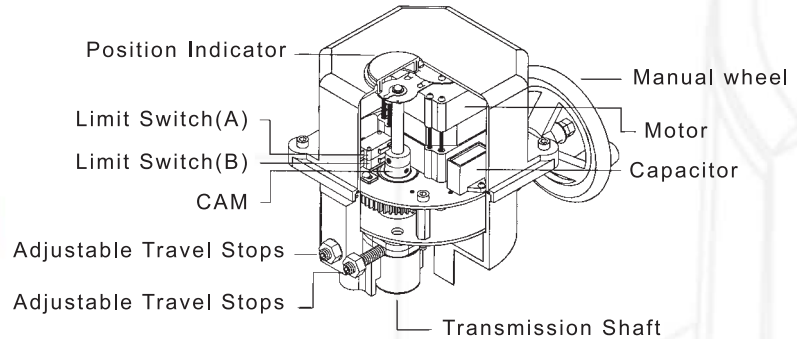

Specification				Speed(sec)		Output Torque Kgf-cm			
Power	110VAC	220VAC	24VDC	AC	DC	110VAC	220VAC	24VDC	
25W	0.76A	0.42A	N/A	1	N/A	294	350	N/A	
				8		1486	1562		
30W	N/A		0.5A	N/A	1	N/A		506	
					8			1660	

The Size Of Valve			
Screwed Ends	Flanged Ends	Butterfly Valve	3-Way Valve
1 1/2" ~ 3"	1 1/4" ~ 3"	2" ~ 4"	2 1/2"

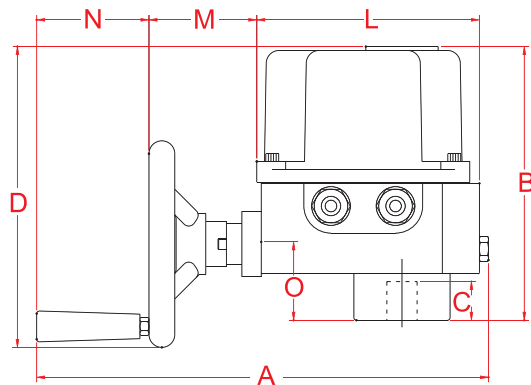

*The UM-3-1/24VDC is over standard height 26mm.

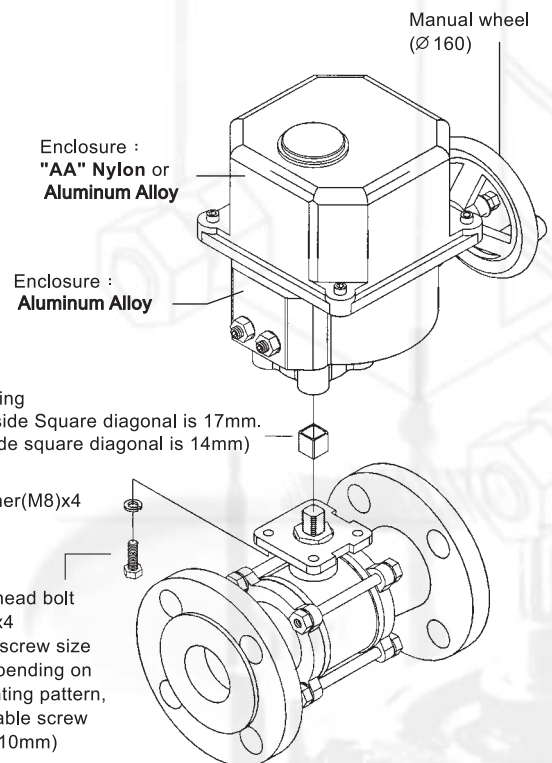
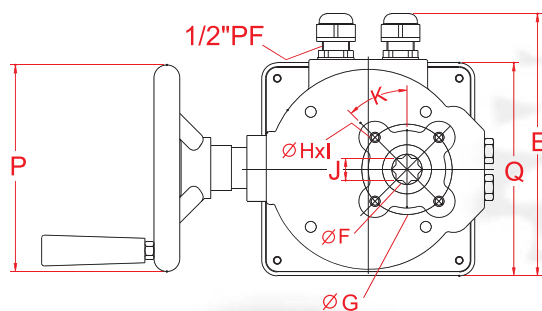

Dimension (mm)	A	B	C	D	E	F	G	H	I	J	K	L	M	N	O	P	Q	ISO 5211
Model																		
UM-3-1	350	215	30	235	203	23.5	70	M5	4	17	45°	173	84	87	59	160	165	F07

UM-4 Direct Mount Series

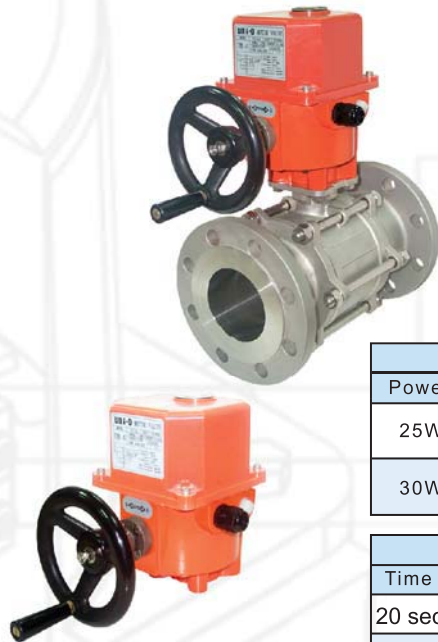

Weight : 8.5 kg

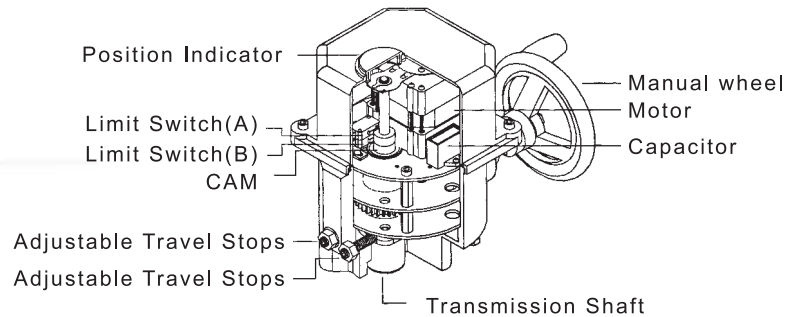

Speification				Speed(sec)		Output Troque Kgf-cm			
Power	110VAC	220VAC	24VDC	AC	DC	110VAC	220VAC	24VDC	
25W	0.76A	0.42A	N/A	20	N/A	2500	2500	N/A	
				30		3118	3320		
30W	N/A		0.5A	N/A	20	N/A		2630	
					30			3400	

The Size Of Valve				
Time	Screwed Ends	Flanged Ends	Butterfly Valve	3-Way Valve
20 sec	2 1/2" ~ 3"	2 1/2" ~ 3"	4" ~ 5"	2 1/2"
30 sec	3" ~ 4"	3" ~ 4"	5" ~ 8"	2 1/2" ~ 3"

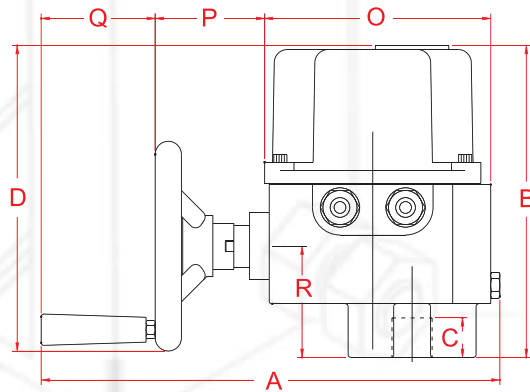

*The UM-4/24VDC is over standard height 26mm.

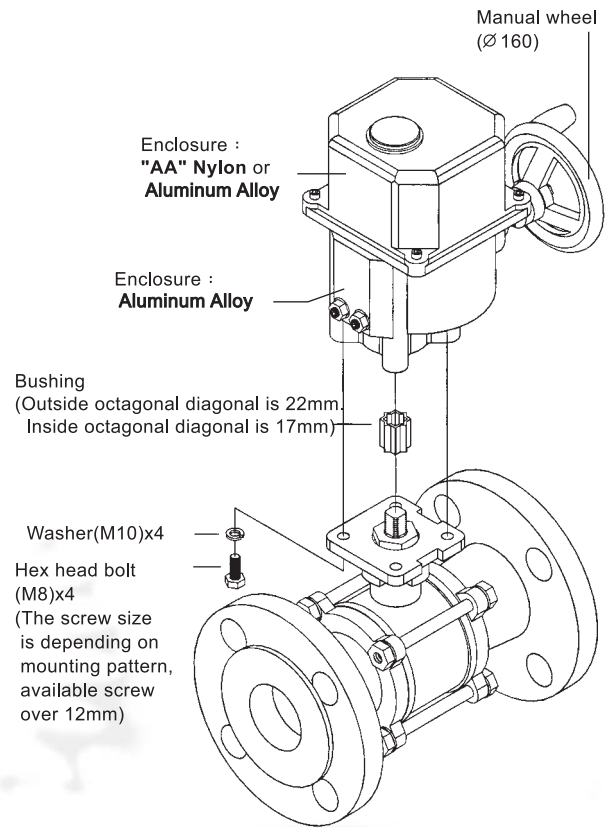
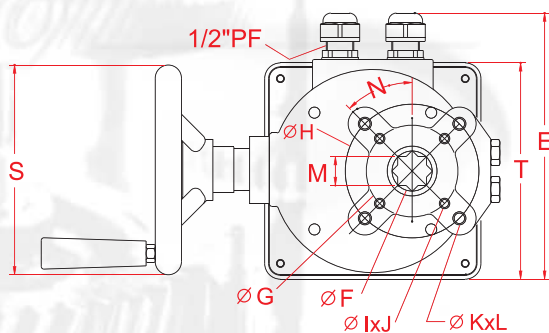

Dimension (mm)	A	B	C	D	E	F	G	H	I	J	K	L	M	N	O	P	Q	R	S	T	ISO 5211
Model																					
UM-4	350	240	30	235	203	30.6	70	102	M8	4	M10	4	22	45	173	84	87	85	160	165	F07/F10

UM-5 Direct Mount Series



Weight : 8.9 kg

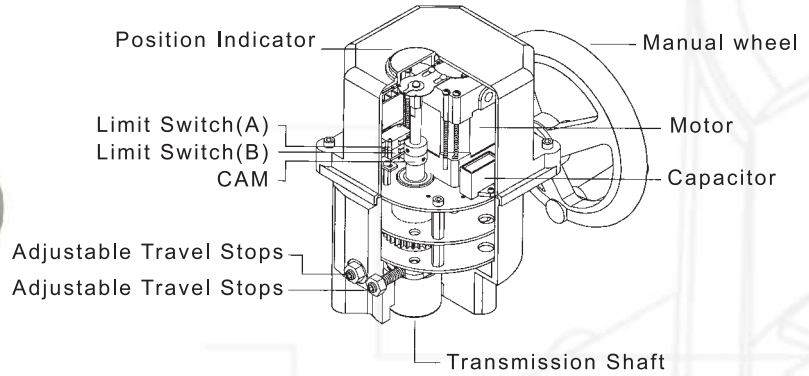

Specification			Speed(sec)		Output Troque Kgf-cm		
Power	110VAC	220VAC	AC	DC	110VAC	220VAC	24VDC
40W	0.95A	0.58A	30	N/A	4266	4873	N/A

The Size Of Valve		
Flanged Ends	Butterfly Valve	3-Way Valve
4" ~ 5"	8" ~ 10"	3" ~ 4"

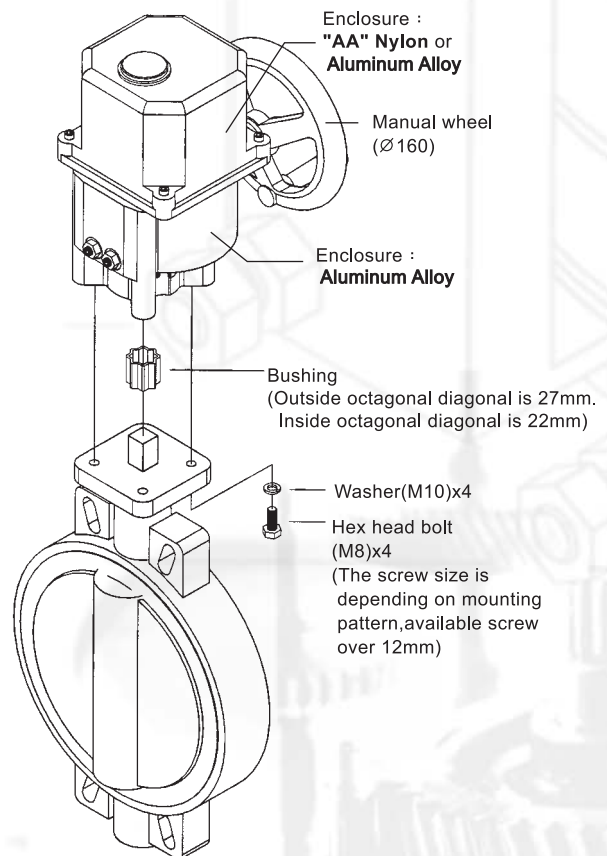
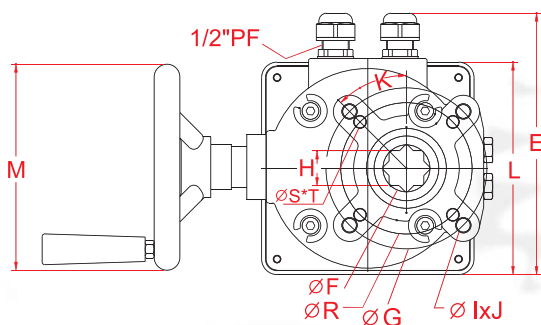
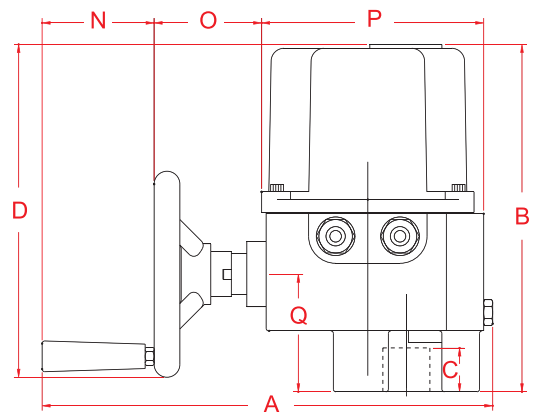

Model	Dimension (mm)																					ISO 5211
	A	B	C	D	E	F	G	H	I	J	K	L	M	N	O	P	Q	R	S	T		
UM-5	350	272	34	260	203	36,6	125	27	M12	4	45°	165	200	87	84	173	92	102	M10	4	F10/F1	

UM-6 Direct Mount Series



Weight : 9.2 kg

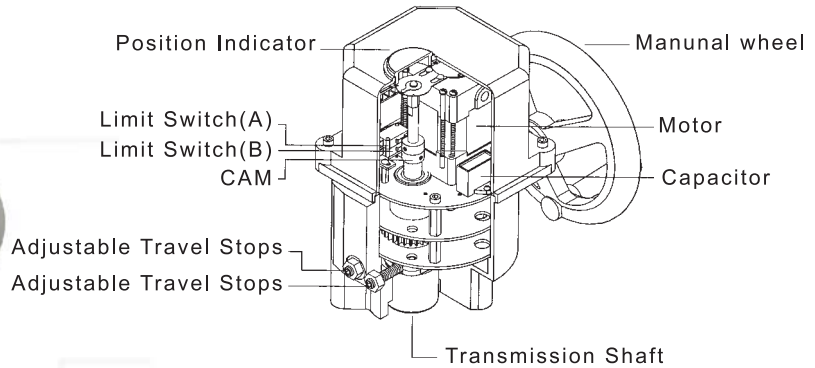

Specification				Speed(sec)		Output Troque Kgf-cm		
Power	110VAC	220VAC	24VAC	AC	DC	110VAC	220VAC	24VDC
60W	1.2A	0.66A	N/A	30	N/A	5689	6081	N/A
65W	N/A		1.5A	N/A	30	N/A		6232

The Size Of Valve		
Flanged Ends	Butterfly Valve	3-Way Valve
5" ~ 6"	10" ~ 12"	4" ~ 5"

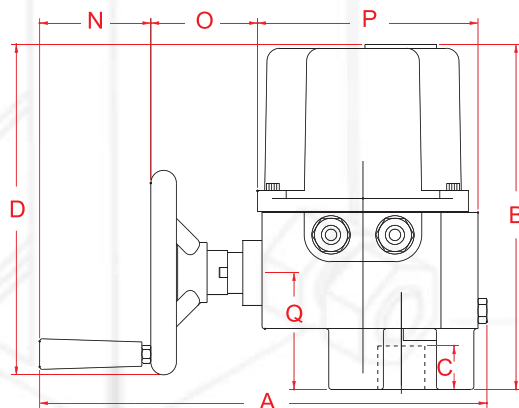

*The UM-6/24VDC is over standard height 33mm.

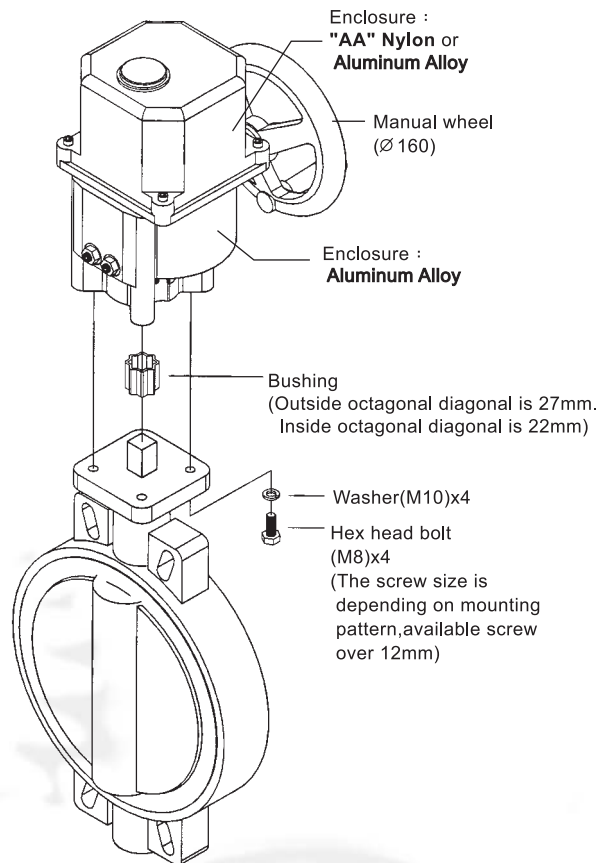
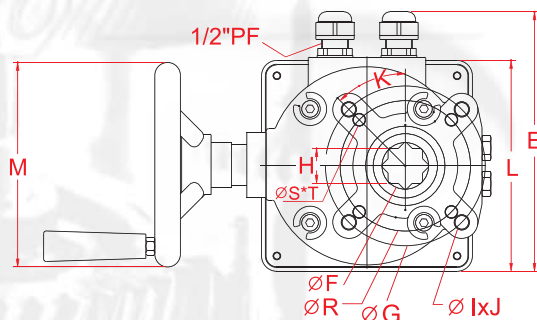

Model	Dimension (mm)																				ISO 5211
	A	B	C	D	E	F	G	H	I	J	K	L	M	N	O	P	Q	R	S	T	
UM-6	350	272	34	260	203	36.6	125	27	M12	4	45°	165	200	87	84	173	92	102	M10	4	F10/F12

UM-1 Series



Weight : 1.5 kg

A (PCD)	Ø 36	Ø 42	Ø 50
B	Ø 7	Ø 8	Ø 8
C	9 [□]	11 [□]	14 [□] (H43, H58)
		10 [□] (H58)	12 [□] (H58)
D	5	6	8

Specification				Speed(sec)		Output Torque Kgf-cm		
Power	110VAC	220VAC	24VDC	AC	DC	110VAC	220VAC	24VDC
10W	0.4A	0.25A	0.5A	1	2	75	80	100
				5	15	181	214	438
15W	0.8A	0.5A	N/A	1	N/A	127	132	N/A
				10		410	432	

The Size Of Valve

Screwed Ends	Flanged Ends	True Union Ball Valve	3-Way Valve
1/4" ~ 1 1/2"	1/2" ~ 1"	1/2" ~ 1 1/2"	1/2" ~ 1"

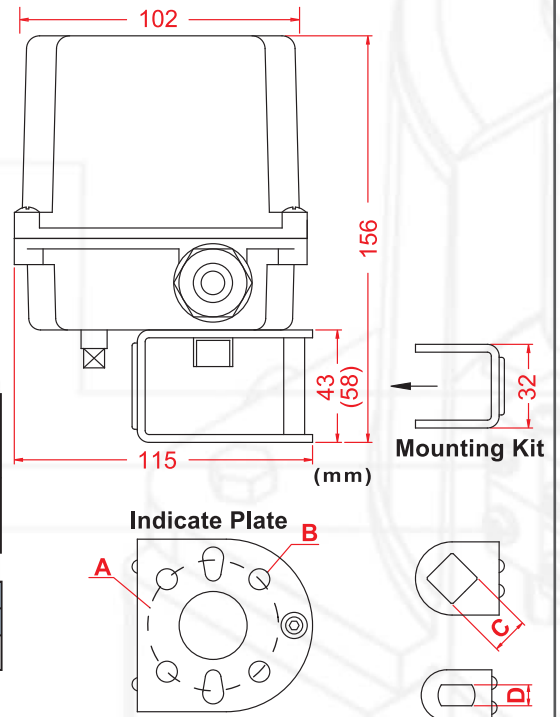

UM-2 Series



Weight : 2.3 kg

H (mm)	60	70
Specification	Butterfly Valve 2" ~ 3"	Flange Ends 2" ~ 3"
	Screwed Ends 1" ~ 2"	

Specification				Speed(sec)		Output Torque Kgf-cm		
Power	110VAC	220VAC	24VDC	AC	DC	110VAC	220VAC	24VDC
10W	0.4A	0.25A	0.5A	20	30	480	502	622
15W	0.8A	0.5A	N/A	20	N/A	655	677	N/A

The Size Of Valve

Screwed Ends	Flanged Ends	True Union Ball Valve	Butterfly Valve	3-Way Valve
1" ~ 2"	1 1/4" ~ 2"	1 1/2" ~ 2"	2" ~ 3"	1 1/4" ~ 1 1/2"

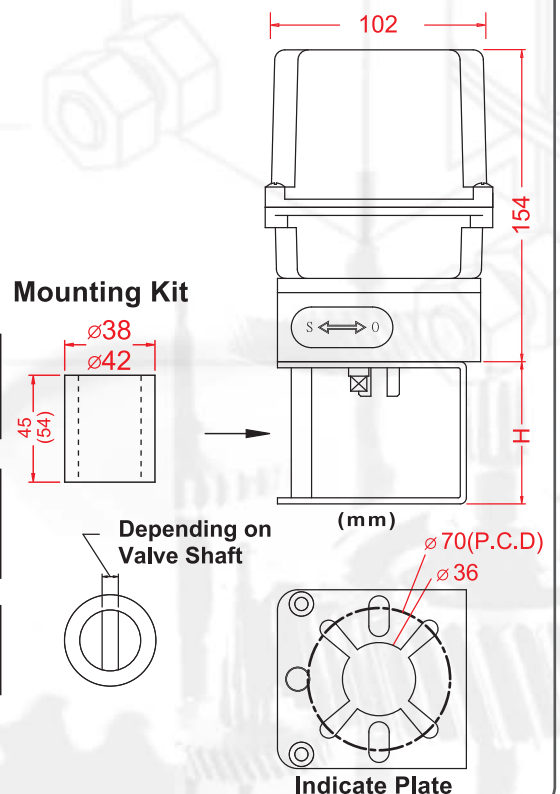

UM-3 Series



Weight : 6 kg

Specification				Speed(sec)		Output Torque Kgf-cm		
Power	110VAC	220VAC	24VDC	AC	DC	110VAC	220VAC	24VDC
25W	0.76A	0.42A	N/A	1 8	N/A	294 1486	350 1562	N/A
30W	N/A		0.5A	N/A	1 8	N/A		506 1660
40W	0.95A	0.58A	N/A	1	N/A	369	405	N/A
60W	1.2A	0.66A	N/A	1	N/A	445	460	N/A

sec	The Size Of Valve				
	Screwed Ends	Flanged Ends	True Union Ball Valve	Butterfly Valve	3-Way Valve
8	1 1/4" ~ 3"	1 1/4" ~ 3"	1 1/4" ~ 3"	2" ~ 4"	1 1/4" ~ 2 1/2"
1	1 1/4" ~ 2"	1 1/4" ~ 2"	1 1/4" ~ 2"	2 1/2"	1 1/4" ~ 2"

*The UM-3/24VDC is over standard height 26mm.

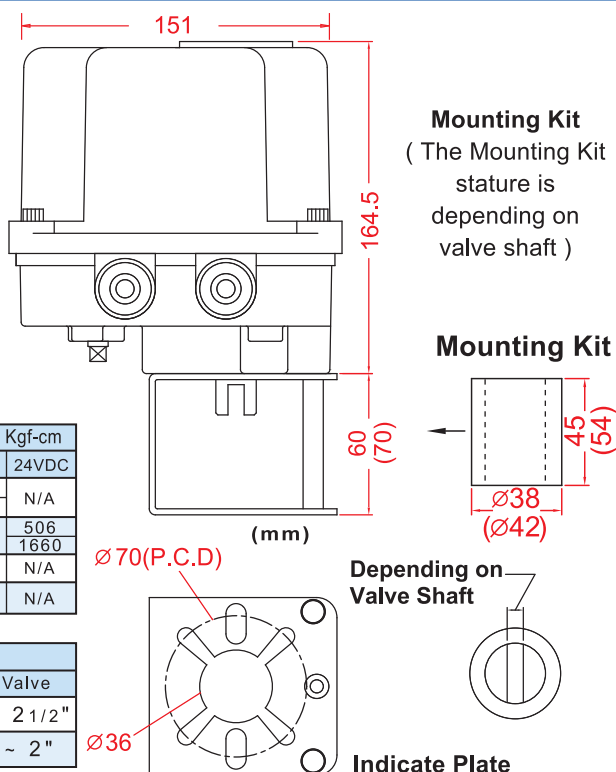

UM-3-1 Series



Weight : 7.5 kg

Specification				Speed(sec)		Output Torque Kgf-cm		
Power	110VAC	220VAC	24VDC	AC	DC	110VAC	220VAC	24VDC
25W	0.76A	0.42A	N/A	1 8	N/A	294 1486	350 1562	N/A
30W	N/A		0.5A	N/A	1 8	N/A		506 1660
40W	0.95A	0.58A	N/A	1	N/A	369	405	N/A
60W	1.2A	0.66A	N/A	1	N/A	445	460	N/A

sec	The Size Of Valve				
	Screwed Ends	Flanged Ends	True Union Ball Valve	Butterfly Valve	3-Way Valve
1 sec	1 1/4" ~ 2"	1 1/4" ~ 2"	1 1/4" ~ 2"	2" ~ 2 1/2"	1 1/4" ~ 2"
8 sec	1 1/4" ~ 3"	1 1/4" ~ 3"	1 1/4" ~ 3"	2" ~ 4"	1 1/4" ~ 2 1/2"

*The UM-3-1/24VDC is over standard height 26mm.

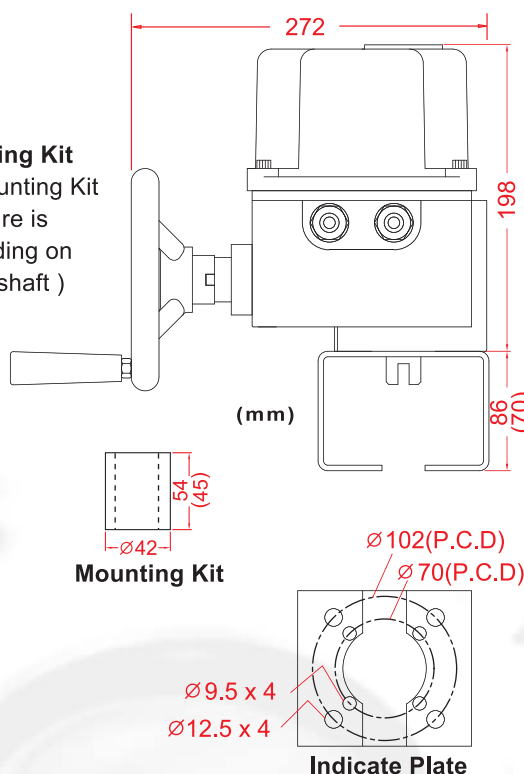

UM-4 Series



Weight : 8.3 kg

Specification				Speed(sec)		Output Torque Kgf-cm		
Power	110VAC	220VAC	24VDC	AC	DC	110VAC	220VAC	24VDC
25W	0.76A	0.42A	N/A	20 30	N/A	2500 3118	2500 3320	N/A
30W	N/A		0.5A	N/A	20 30	N/A		2630 3405

sec	The Size Of Valve				
	Screwed Ends	Flanged Ends	True Union Ball Valve	Butterfly Valve	3-Way Valve
20	1 1/4" ~ 3"	1 1/4" ~ 3"	1 1/4" ~ 3"	2" ~ 5"	1 1/4" ~ 2 1/2"
30	3" ~ 4"	3" ~ 4"	3" ~ 4"	5" ~ 8"	2 1/2" ~ 3"

*The UM-4/24VDC is over standard height 26mm.

Mounting Kit
(The Mounting Kit
stature is
depending on
valve shaft)

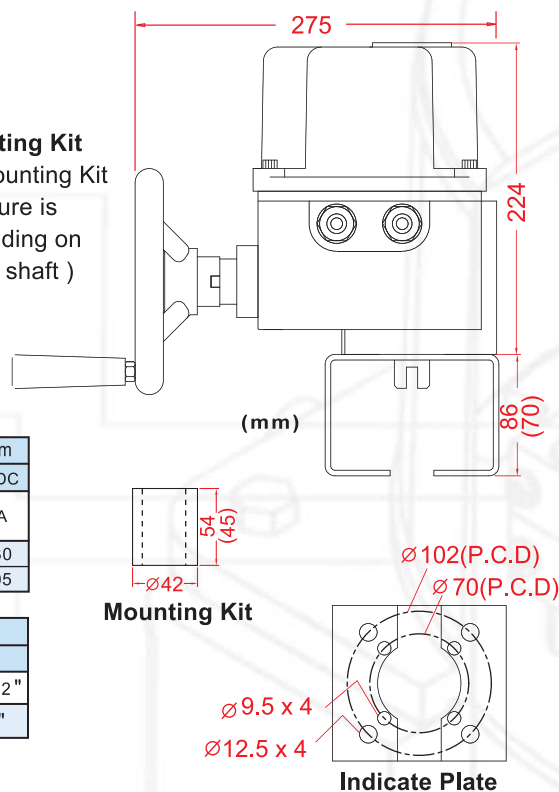

UM-5 Series



Weight : 10.8 kg

Specification				Speed(sec)		Output Torque Kgf-cm		
Power	110VAC	220VAC		AC	DC	110VAC	220VAC	24VDC
40W	0.95A	0.58A		30	N/A	4266	4873	N/A

The Size Of Valve		
Flanged Ends	Butterfly Valve	3-Way Valve
4" ~ 5"	8" ~ 10"	3" ~ 4"

Mounting Kit
(The Mounting Kit
stature is
depending on
valve shaft)

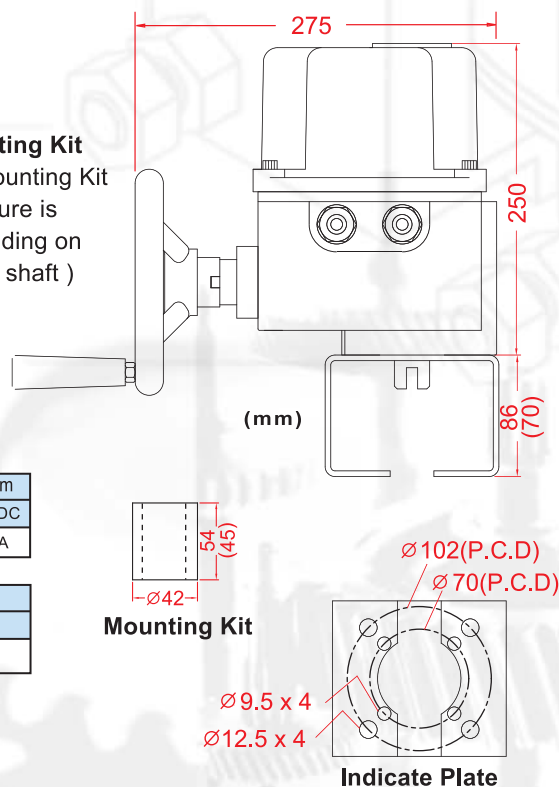

UM-6 Series



Weight : 11 kg

Power	Specification			Speed(sec)		Output Torque Kgf-cm		
	110VAC	220VAC	24VDC	AC	DC	110VAC	220VAC	24VDC
60W	1.2A	0.66A	N/A	30	N/A	5689	6081	N/A
65W	N/A		1.5A	N/A	30	N/A 6232		

The Size Of Valve		
Flanged Ends	Butterfly Valve	3-Way Valve
4" ~ 6"	10" ~ 12"	5"

*The UM-6/24VDC is over standard height 33mm.

Mounting Kit
(The Mounting Kit stature is depending on valve shaft)

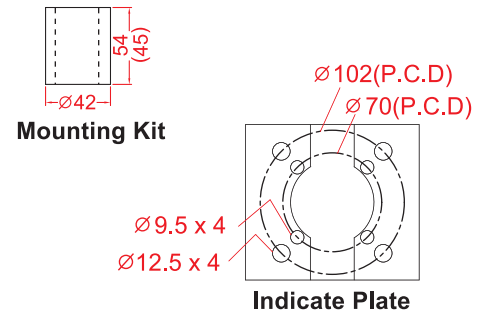
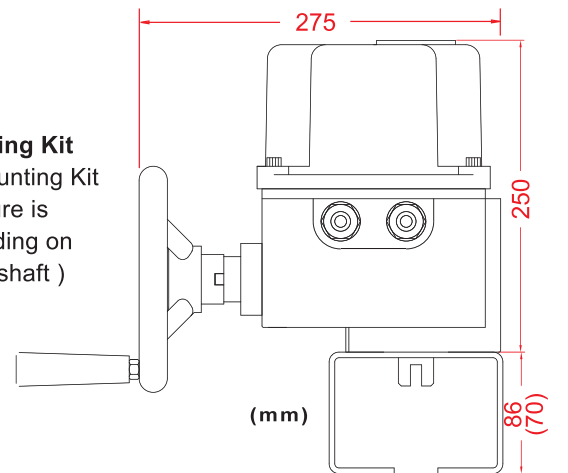

Position Control

- **Position control of output signal :**
five kind of output signal
(can be switched).
- **100~120VAC and 200~250VAC**
(can be switched).
- **It can be flow rate position indication.**

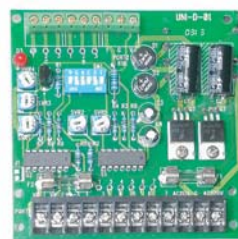

Position control panel



Controller

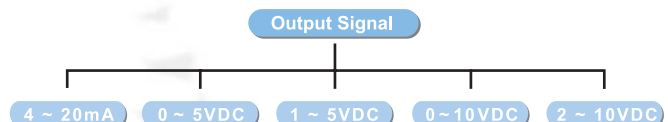

① Function :

The valve position transform to signal.

② Flow chart :

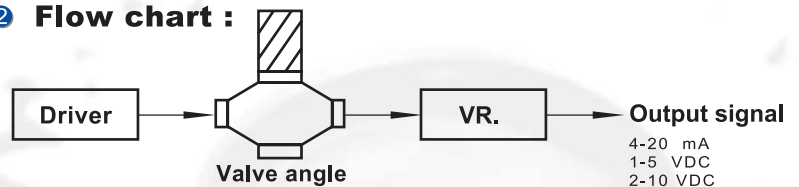

UM-8 Series



Weight : 32 kg

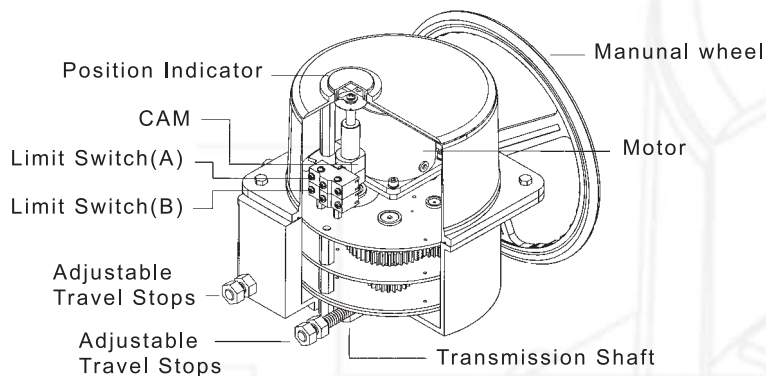

Specification			Speed(sec)		Output Troque Kgf-cm		
Power	110VAC	220VAC	AC	DC	110VAC	220VAC	24VDC
100W	0.92A	0.34A	37	N/A	11038	9296	N/A

The Size Of Valve		
Flanged Ends	Butterfly Valve	3-Way Valve
6" ~ 8"	12" ~ 14"	5" ~ 6"

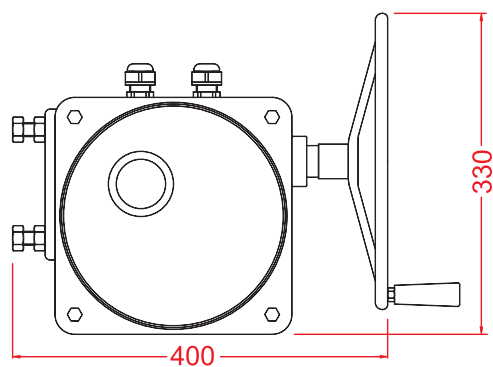

(mm)

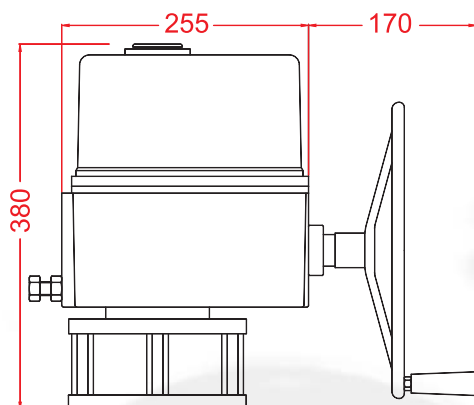

Mounting pattern is depending on valve

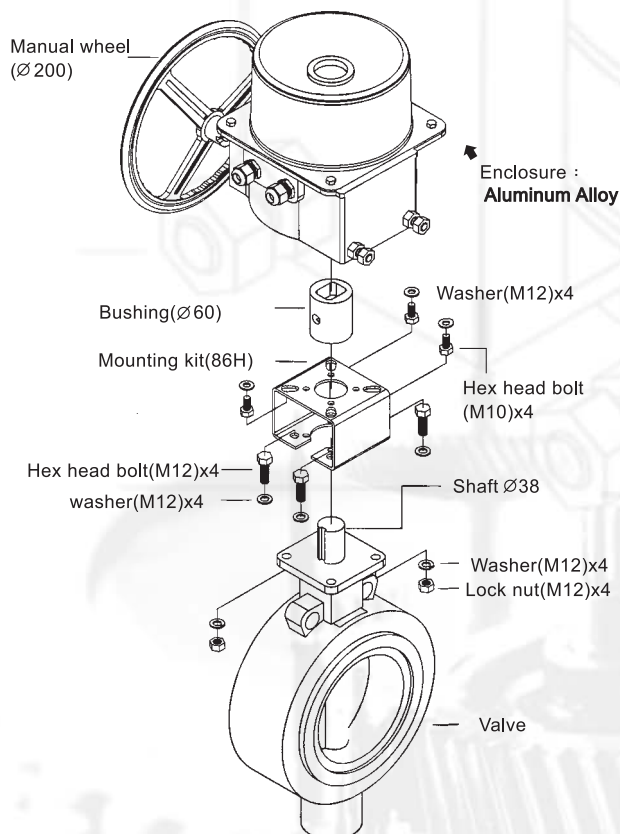

UM-10 Series



Weight : 34 kg

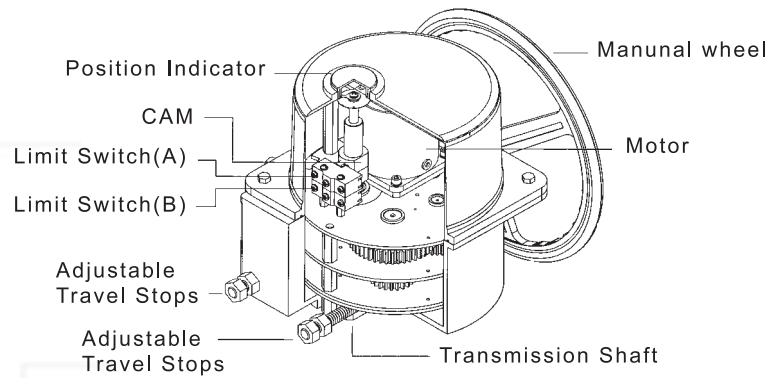

Specification			Speed(sec)		Output Troque Kgf-cm		
Power	110VAC	220VAC	AC	DC	110VAC	220VAC	24VDC
100W	0.92A	0.34A	52	N/A	12060	13500	N/A

The Size Of Valve	
Flanged Ends	Butterfly Valve
8" ~ 10"	14" ~ 16"

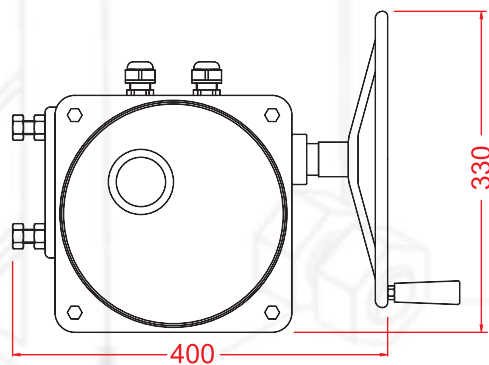

(mm)

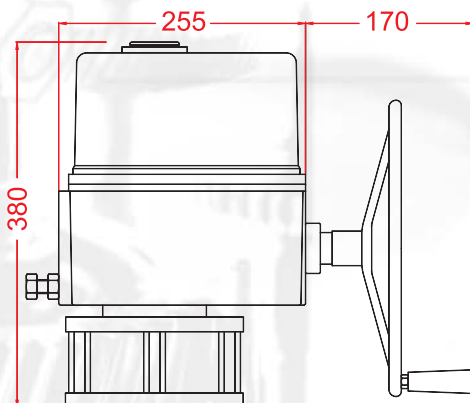

Mounting pattern is depending on valve

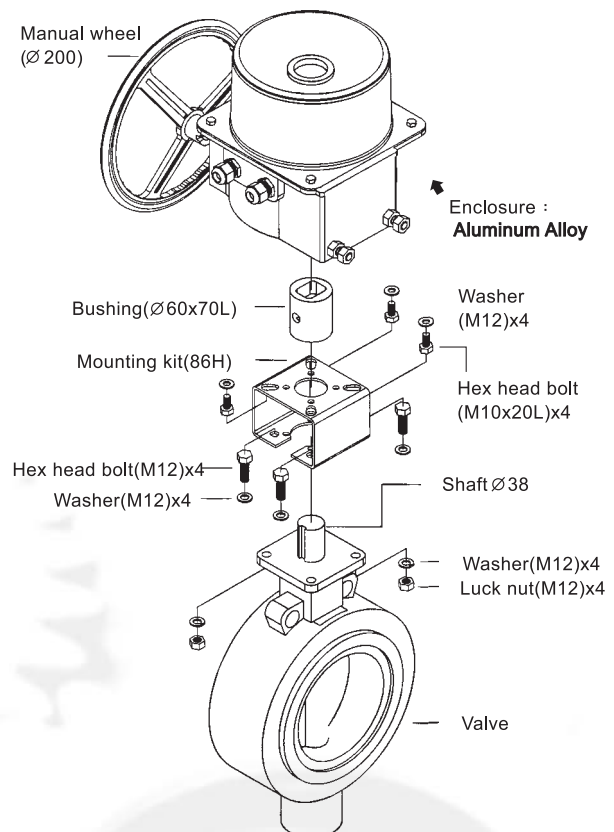

UM-11 Series



Weight : 34 kg

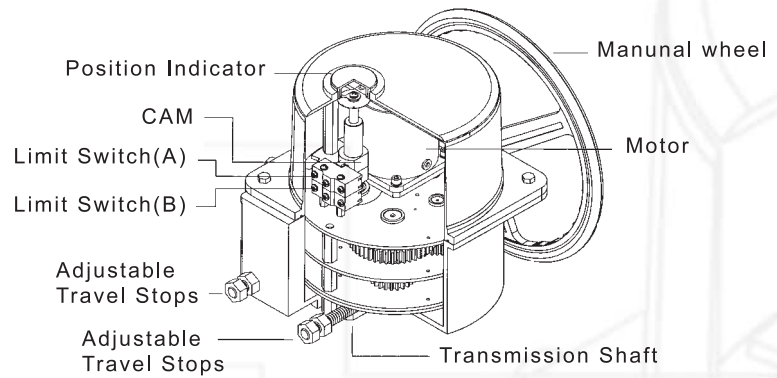

Specification			Speed(sec)		Output Troque Kgf-cm		
Power	110VAC	220VAC	AC	DC	110VAC	220VAC	24VDC
100W	0.92A	0.34A	65	N/A	15000	14500	N/A

The Size Of Valve	
Flanged Ends	Butterfly Valve
10" ~ 12"	16" ~ 18"

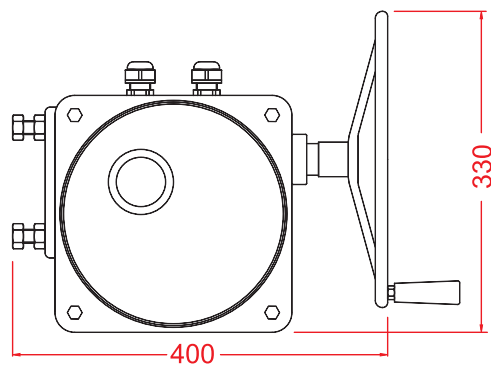

(mm)

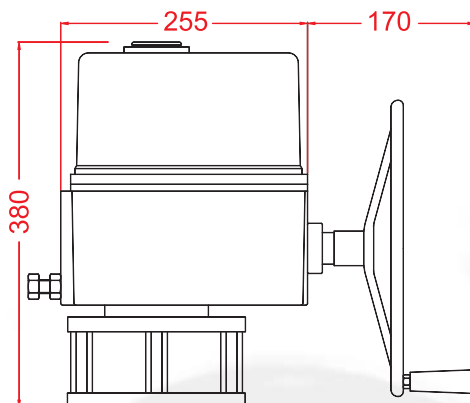

Mounting pattern is depending on valve

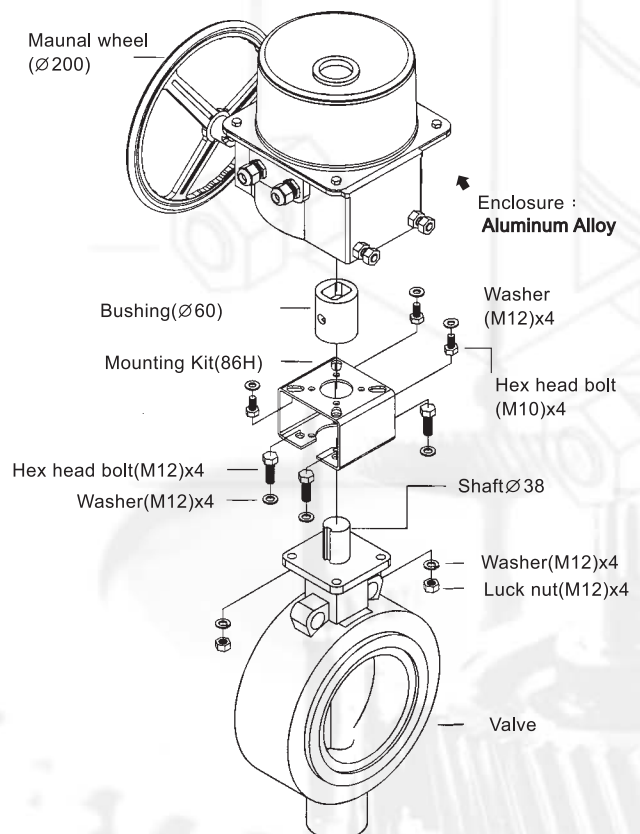

UM-12 Series



Weight : 60 kg

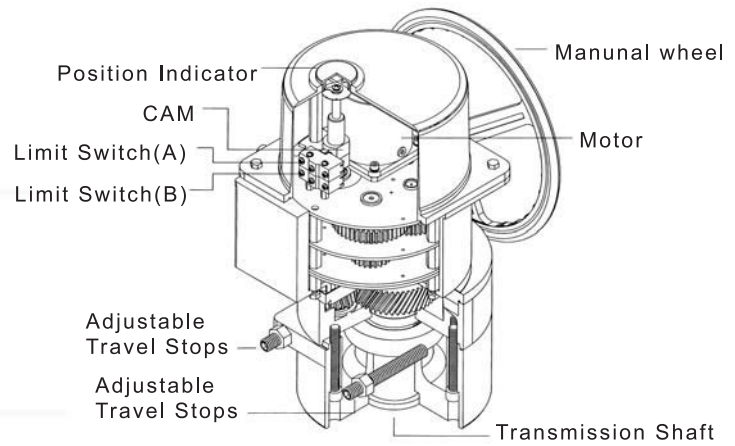

Specification			Speed(sec)		Output Troque Kgf-cm		
Power	110VAC	220VAC	AC	DC	110VAC	220VAC	24VDC
100W	0.92A	0.34A	143	N/A	35000	35000	N/A

The Size Of Valve	
Flanged Ends	Butterfly Valve
12" ~ 14"	20" ~ 24"

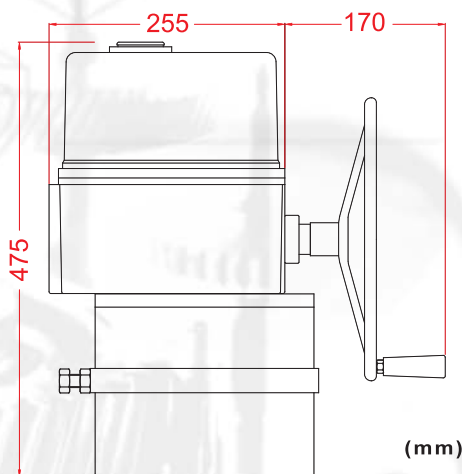
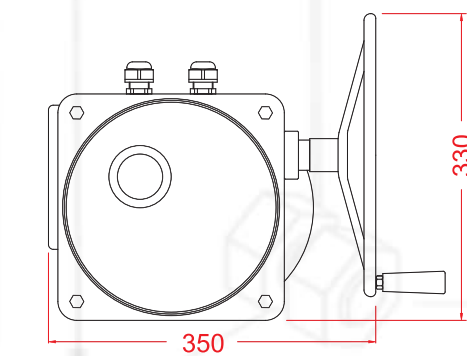

Mounting pattern is depending on valve

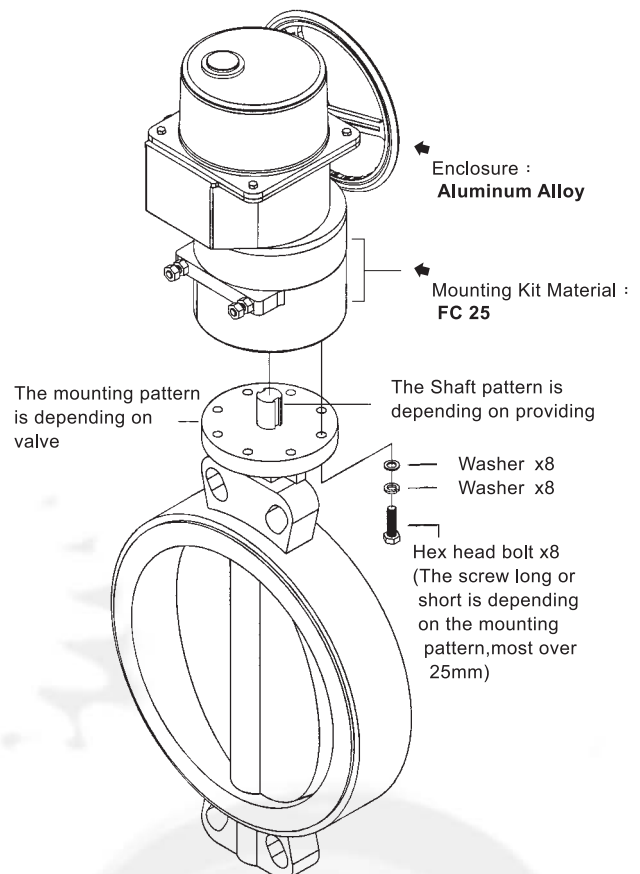

UM Series For Gate Valve

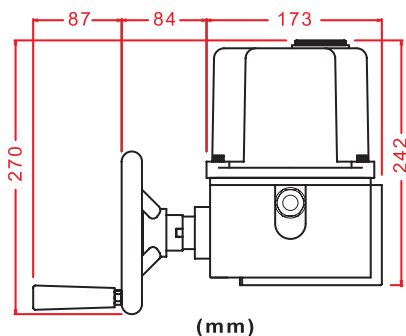

General Description :

1. UM electric actuator for gate valve, knife valve, bellows valve.
2. UM for Bellows valve: 3/4" Gate valve: 1-1/2" to 4" Globe Valve: 1-1/2" to 3" Knife Valve: 2" to 6"
3. The distance is 20mm to 150mm.
4. The series standard voltage is 110VAC/220VAC, 24VDC. 50/60Hz , other special voltage is 3 phase 220VAC/380VAC

Feature :

1. UM series electric actuator is suitable high pressure and high temperature.
2. UM series electric actuator can use in solid state fluid such as paper factory.
3. UM series electric actuator have thermal protector is installed.
4. UM series electric actuator series provide waterproof . It is suitable outdoor environment
5. UM series electric actuator series provide position indicator.
6. UM series electric actuator series provide manual wheel for electric power cut.

Enclosure :

1. UM main body is Aluminum Alloy.
2. Cover is made of "AA" 「NYLON」 which has purpose of resisting against heat, acid and alkali, waterproof, dustproof.

General Description :

The temperature controller provide the control of open and close valve.

Feature :

1. Multi range input (TC, RTD, mV, mA, DCV, SCL)
2. Two PID control outputs
3. Free power supply 85~265 VAC
4. Data lock function
5. open loop valve motor drive is available

Specification :

Power supply : 85~265 VAC 50/60Hz
Memory element : EEPROM
Operation condition : celsius 0~50°C 35~85% RH
Stock condition : celsius -25~65°C 35~85%



UM Modulating Series

Modulating Controller

General Description :

1. The UM series is Modulating Controller. It is suitable for UM-1 to UM-12.
2. The UM series provide proportion control.
3. The UM-1 and UM-2 install Extra box, UM-3 to UM-12 install inside.

Specification :

Power Requirement: 100VAC~120VAC

200VAC~250VAC

Signal Input: 4~20mA, 1~5VDC, 2~10VDC

Feature :

1. Position Indicator : All series have position indication.
2. Joints Waterproof : All the joints on the housing are armed with waterproofing seal, which is applicable for use in outdoor environment.
3. Manual device : UM-3-1 to UM-12 provide manual device at the side part. During the power shutdown, such manual shaft. can be used to proceed with the switch action.
4. Support constant temperature control.

Enclosure :

1. IP67 waterproof and dustproof enclosures.
2. Made of "AA"「NYLON」 or Aluminum Alloy which has purpose of resisting against heat, acid , alkali, waterproof, dustproof.
- *3. UM-1, UM-2 with modulating : The top cover is over standard specification 16.5mm.
UM-3, UM-4 with modulating : The top cover is over standard specification 26mm.

Signal Input :

1. The DIP provide three kind of signal 4~20mA, 1~5VDC, 2~10VDC or voltage.
2. The input signal can be adjustable on your request of valve position.

Working Ambient Temperature :

-10°C ~ 60°C

Cautions :

1. Make sure voltage , pressure , fluid , temp before installed.
2. Please install regulated voltage when the voltage is not stable.
3. Make sure input signal of 4~20mA, 1~5VDC or 2~10VDC.
4. To avoid the signal interfere each other , please separate signal wire and power wire.



Proportional Power Controlled Regulator (OPTION)

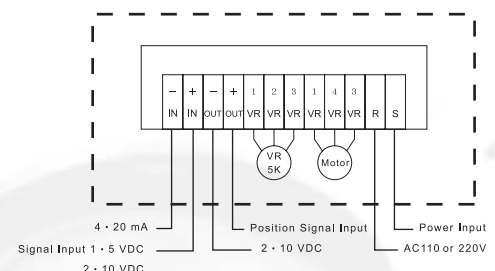

1sec Electric Actuator Series

UM-1 and UM-3 Electric Actuator for 1 Second

Specification :

Power Requirement : 100~120VAC
200~250VAC
24VDC

UM-1 FAST Close Time : AC 1 sec , 5 sec / DC 2 sec

UM-1 FAST Open Time : AC 1 sec , 5 sec / DC 2 sec

UM-1 for 5 seconds/AC provide modulating controller.

UM-3~UM-3-1 FAST Close Time : AC 1 sec / DC 1 sec

UM-3~UM-3-1 FAST Open Time : AC 1 sec / DC 1 sec

MAX OPERATING PRESSURE DIFF: 10 Kgf/cm²



Feature :

1. Quick open/close.
2. Position Indicator : All series have position indication on the top of actuator cover.
3. Joints Waterproof : All the joints on the housing armed with waterproofing seal, which is applicable for use in outdoor environment.
4. Manual Device : The manual device provide at the bottom part. During the power shutdown, manual can be used (Tool : 8 mm spanner).
5. Motor vale can replace pneumatic electric actuator, and motor valve does not need Compressed Air.

Enclosure :

1. IP67 waterproof and dustproof enclosure.
2. Made of "AA" 「NYLON」 which has the purpose of resisting against heat ,acid and alkali, waterproof ,dustproof.

Cautions :

1. Electric actuator away from the area using gas or chemical substance which is vulnerable to gas explosion to avoid the occurrence of hazard.
2. Be sure to voltage and wiring is correct.
3. The inner part have to clear before installed.
4. Adjusting valve position: open cover then adjusting the CAM (Hexagonal head wrench 2.5H). After complete adjusting , be sure to screw is tight .

Working Ambient Temperature :

-10°C ~ 60°C

Electric actuator specification for 1sec,2sec,5sec				
Screwed Ends	Flanged Ends	Butterfly Valve	PVC	3-Way Valve
1/4" ~ 2"	1/2" ~ 2"	2" ~ 3"	1/2" ~ 2"	1/2" ~ 2"
*Above valve body is form our company.If you have special requirement ,please contact us.				

Standard Instructions Of Hook-Up

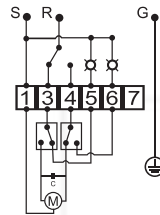
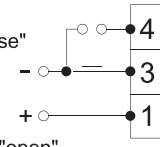
Standard Specification	Option Specification	
110VAC/220VAC	Heater	24VDC
<p>(1) 1 is S phase of power source.</p> <p>(2) R phase and 3 are at "open"</p> <p>(3) R phase and 4 are at "close"</p> <p>(4) 5 is the "open" indicator.</p> <p>(5) 6 is the "close" indicator.</p>	 <p>(1) The heater connect 1 and 7.</p> <p>(2) The On/Off install at 7, 1 connect with motor.</p>	<p>(1) "+" connect 1 "-" connect 3 is "close"</p> <p>(2) "+" connect 1 "-" connect 3, the 3 and 4 connection is "open"</p> <p>(or other DC voltage)</p> 

(*Optional) Extra limit switch. (Model:UM-1 ~ UM-12)

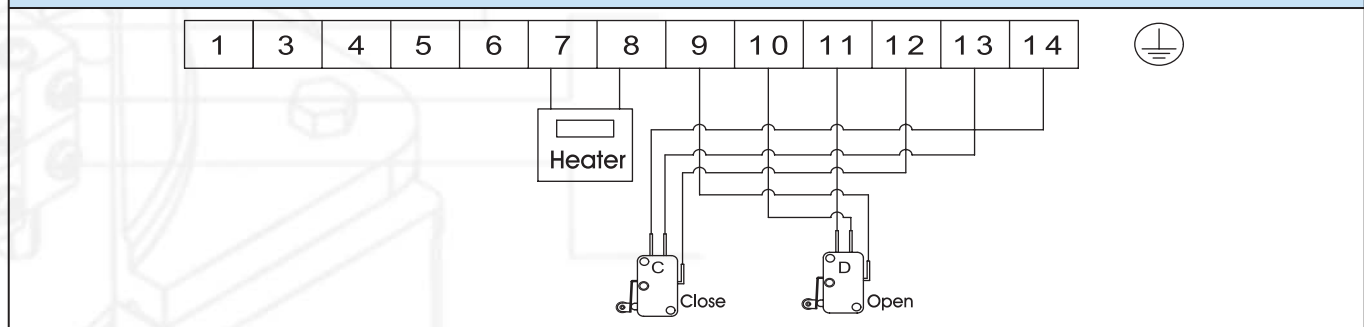



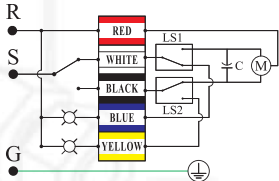
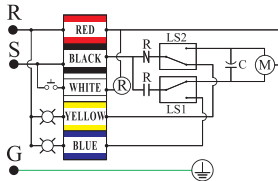
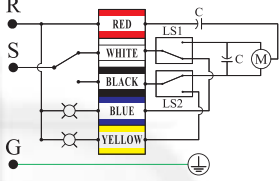
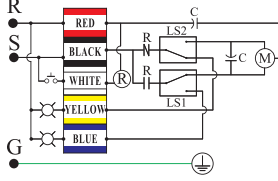

UMS Series Instructions Of Hook-Up

Standard	Optional
No Install Relay	Install Relay
<p>1. The Red is main line.</p> <p>2. The White is "OPEN".</p> <p>3. The Black is "CLOSE".</p> <p>4. The Blue is "OPEN INDICATOR".</p> <p>5. The Yellow is "CLOSE INDICATOR".</p>	<p>1. It is "OFF" when the Red and the Black is power source.</p> <p>2. The White and Black parallel connection is "OPEN"</p> <p>3. The Yellow is "CLOSE INDICATOR"</p> <p>4. The Blue is "OPEN INDICATOR".</p>
<p>110VAC / 24VAC</p> 	<p>110VAC / 24VAC</p> 
<p>220VAC</p> 	<p>220VAC</p> 

Reference only

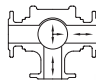
3-Way Valve Dimension

	3WAY-3PORT T TYPE				3WAY-2PORT L TYPE
	Set 1	Set 2	Set 3	Set 4	Set 5
Direction (open)					
Direction (stop)	